



OFFERS IN EXCESS OF

**£700,000**

**The Chase**

, BR1 3DF

## PROPERTY SUMMARY

CHAIN FREE! Located on the ever popular 'Palace Estate' just 0.3 miles from Bromley South Railway Station is this spacious three bedroom semi-detached home. Offering in our opinion excellent potential to extend further (STPP). The accommodation of some 1385 sq ft comprises as follows; to the ground floor, entrance hall, two reception rooms, galley kitchen and w.c. The first floor provides three bedrooms, the family bathroom and separate W.C. off a landing. Externally there is a mature and generous south facing rear garden whilst to the front of the property is a driveway providing off road parking and access to the garage.

EPC: D  
Freehold  
COUNCIL TAX - F  
Construction - Traditional  
Mains Services - Yes  
Heating System - Gas radiators  
Broadband - Yes  
Mobile coverage - Good  
Restrictive covenants - No

3



1



2





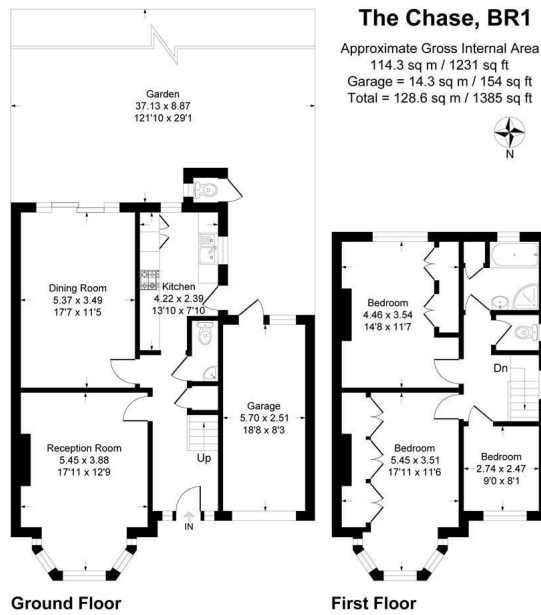

This plan is for layout guidance only. Not drawn to scale unless stated. Windows and door openings are approximate. Whilst every care is taken in the preparation of this plan, please check all dimensions, shapes and compass bearings before making any decisions reliant upon them.  
 Produced By Planpix

3  
1  
2

Energy Efficiency Rating		Current	Potential
Very energy efficient - lower running costs			
(92 plus) A			
(81-91) B			
(69-80) C			78
(55-68) D		63	
(39-54) E			
(21-38) F			
(1-20) G			
Not energy efficient - higher running costs			
England & Wales		EU Directive 2002/91/EC	

**EPC RATING: D COUNCIL TAX BAND: F**

Agents Note: Whilst every care has been taken to prepare these particulars, they are for guidance purposes only. All measurements are approximate and are for general guidance purposes only and whilst every care has been taken to ensure their accuracy, they should not be relied upon and potential buyers/tenants are advised to recheck the measurements

Sinclair Hammelton

**OFFICE ADDRESS**  
 23 High Street  
 Bromley  
 Kent  
 BR1 1LG

**OFFICE DETAILS**  
 0208 464 5566  
 info@sinclairhammelton.co.uk